

Go faster from question to answer.



Make better decisions, sooner.

The compact, efficient KDR™ Advanced U-Arm (AU) System from Konica Minolta features an array of advanced design innovations to **optimize workflow, increase staff efficiency and improve outcomes**, expediting the diagnostic process and elevating the patient experience. That makes it an excellent option for all clinical settings.

A Time-Saving System that Revolves Around the Patient

The KDR Advanced U-Arm System automatically swivels into position across a 135° range of motion and 35" of vertical movement, saving valuable time. The advanced detector and Ultra acquisition software work in unison to enhance the acquired image. Information is instantly retrieved, prompting the system to move to a predetermined position and source-to-image-receptor distance (SID) to save time when positioning the patient.

Exams are simplified when the operator can confirm the patient's information on the tube-mounted console. After exposure, the image is captured and displayed for on-screen review within three seconds. Upon approval, the automated preparation begins for the next exam, minimizing time between patients.



Superior Image Quality, for Confident Diagnoses

The KDR Advanced U-Arm System employs a state-of-the-art, 17"x17" Cesium iodide (CsI) detector that maximizes efficiency and delivers image quality with excellent bone and soft-tissue visualization from a single study exposure, giving you the clarity to reach diagnoses sooner. The system maintains alignment between the X-ray tube and DR panel, regardless of panel angle or swivel arm tilt position. A durable, protective panel enclosure also helps to increase system longevity and stability.

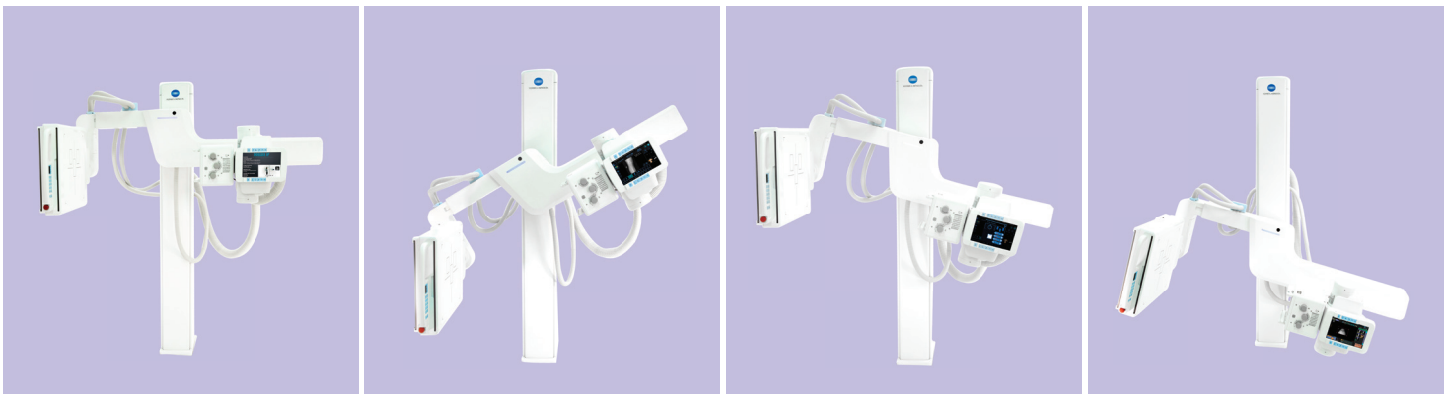

The KDR Advanced U-Arm can move from PA to Lateral positions without moving the patient. Independent SID control on the tube and detector support all other imaging views commonly required in radiology, including wheelchair and table work.

The Perfect Fit

The versatile, compact design of the KDR Advanced U-Arm System makes it ideal for locations that need to provide superior-quality radiography services in relatively small spaces.

The flexible floor-mounted system accommodates 8' ceilings, maximizing every square foot of office space and improving positioning capabilities. It uses a small form factor detector for head-end and foot-end access, simplifying anatomy positioning by placing the patient in front or behind the detector to optimize positioning.

- 1. The floor-to-wall-mounted main column** supports vertical movement with a dual-speed, motorized swivel arm.
- 2. The swivel arm** features a 135° range of motion with detents at 0°, 30°, 90° and 120°, plus 39" of vertical arm movement.
- 3. A tube mounted inter-phase control option.**
- 4. An advanced collimator** employs a linear laser beam with light field indicator and three-knob manual control to optimize patient positioning.
- 5. A 440 lb. capacity mobile patient table** comes standard with every U-Arm DR system.
- 6. Detector side control.**
- 7. Multi-purpose patient positioning indicator.**

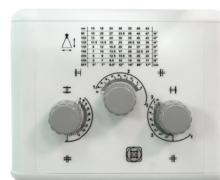
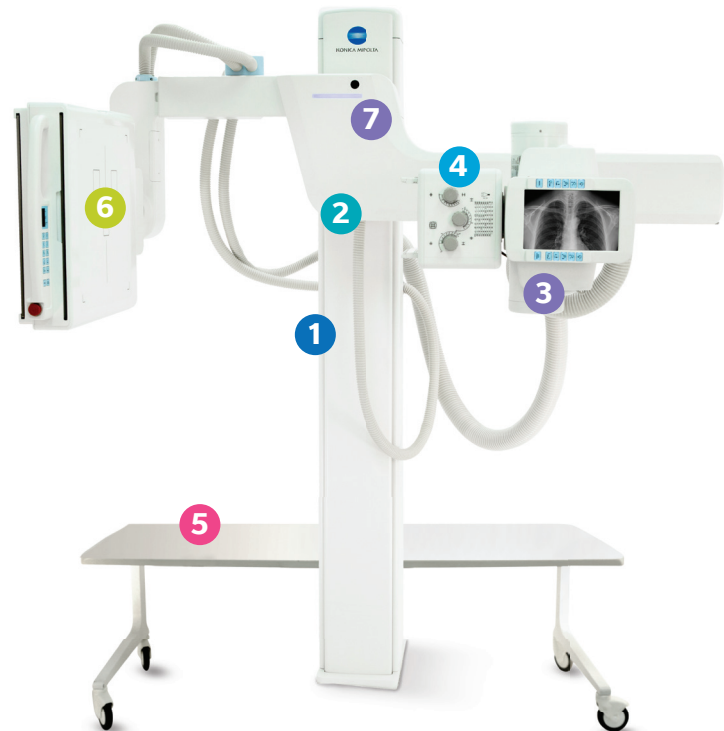

KDR Advanced U-Arm offers optional automatic stitching and a three-knob collimator that provides precise manual control over the imaging area to reduce radiation scatter.

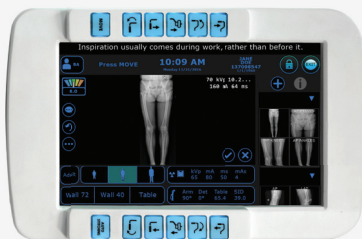

Highly Intuitive Controls Improve Workflow

The KDR Advanced U-Arm System user interface puts all vital decision-making information front and center for the operator, helping facilitate faster, more confident decisions. User-friendly controls include those for making dual-speed motorized movements and for operating the advanced anti-collision system that makes patient positioning fast, easy and safe.

KDR™ AU System Advanced U-Arm

Key Features

Standard

- Floor-mounted U-Arm
- Ultra acquisition software
- Fits spaces with 8' ceilings
- Mirror tube head and console control
- Auto positioning
- 17"x17" CsI detector
- Wide range of swivel arm motion
- 440 lb. capacity mobile patient table

Specifications

X-Ray System	
System Type	Floor Mounted U-Arm
Automation	Auto positioning pre-programmed U-Arm positions
Generator and Tube	Multiple configurations available
High Speed Motorized Movement	1. Source to Image Distance (SID) 2. Arm Elevating Movement: Detector Arm/ Tube Arm 3. Rotation of Arm & Tube 4. Rotation of Bucky
Source to Image	1000~1800mm (39.5~71 in.)
Vertical Travel	40~170 cm (15.7~66.9 in.)
Arm Rotation Angle	-30°~120°
Tube Rotation	±90°
Detector Rotation	±45°
Motion Control	Tube head, detector and wireless remote control

Ultra Workstation	
System Platform	Desktop workstation with touchscreen – duplicate screen on tube head DICOM 3.0 Compliant features –imaging, annotation, and analysis tools

Detector and Subsystems	
Built-in Detector	17"x17" amorphous silicon digital detector
Scintillator (fluorescent substance)	CsI (Cesium iodide)
Detection Quantum Efficiency (DQE)	65% @ 0.0 cyc/mm
Pixel Size	175 um
A/D Conversion	16 bit (65,536 gradients)
Dynamic Range	4 digits
Image Area Size	425.25 x 425.25 mm (2430 x 2430 pixels)
Preview Display Time	under 3 seconds
Exposure Interval (cycle time)	3-5 seconds (wired connection)

Optional	
Automatic Stitching	
3-knob Collimator	
Pediatric Imaging Protocols	
Weight Bearing Stand	
Advanced Weight Bearing Stand	
Elevating Table	
Stitching Stand	
DAP Meter	

The information, specifications, and product appearance contained herein are subject to change without notice. The company names and product names contained herein are trademarks or registered trademarks of their respective owners.

Cost-Saving Preventive Maintenance

To minimize downtime, maximize productivity and mitigate risk over a long functional life, the Konica Minolta Blue Moon service offering for the KDR Advanced U-Arm System goes beyond typical warranty and equipment servicing to include onsite and ongoing remote support, technical assistance and applications training. Choose from three plan levels—Blue Moon Elite, Select or Basic—to meet your needs and budget.

KDR is a trademark of Konica Minolta, Inc.
© 2016 Konica Minolta Healthcare Americas, Inc.



Konica Minolta Healthcare Americas, Inc.
411 Newark Pompton Turnpike
Wayne, New Jersey 07470
Tel: (973) 633-1500 Fax: (973) 523-7408
konicaminolta.com/medicalusa

M1009 1116 RevA